

REVISION DATE
07-13-2001
02-26-2010

*DGN FILE NAME
PM-14

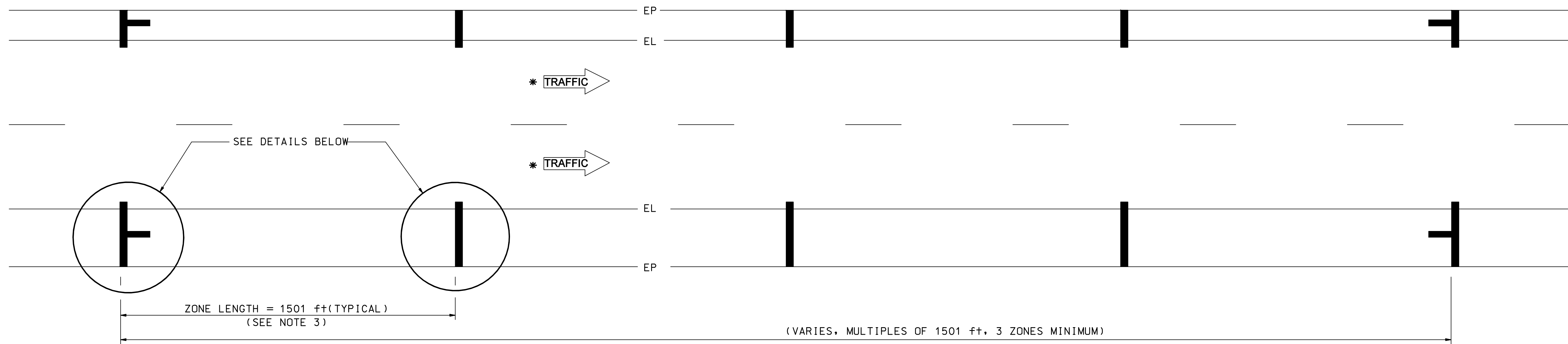

LAYOUT DETAILS

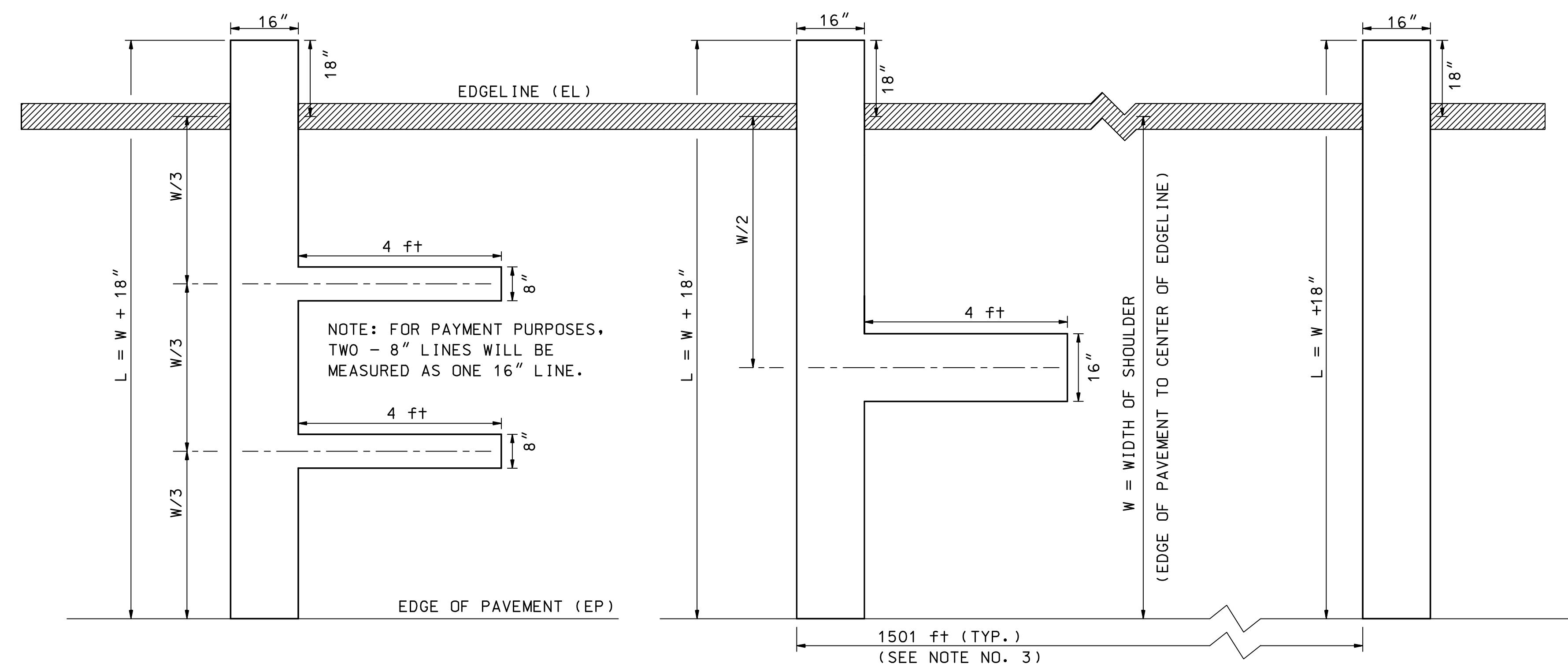

APPROACH END PATTERN - ALTERNATE
(DEPARTURE END OPPOSITE IN KIND)
(SEE NOTE NO. 2)

APPROACH END PATTERN - STANDARD
(DEPARTURE END OPPOSITE IN KIND)

INTERMEDIATE PATTERN

PAVEMENT MARKING DETAILS

RIGHT SHOULDER SHOWN - LEFT SHOULDER
OPPOSITE IN KIND (SEE NOTE NO. 2)

GENERAL NOTES

1. ALL SPEED ZONE MARKINGS SHALL BE SOLID WHITE.
2. ALTERNATE APPROACH END PATTERN SHALL BE USED FOR 3 ZONE LAYOUT ONLY. STANDARD PATTERN SHALL BE USED IN LIEU OF ALTERNATE PATTERN FOR LEFT SHOULDER WIDTHS LESS THAN 8 ft.
3. LONGITUDINAL DISTANCES SHALL BE MEASURED BY NHDOT SURVEY PERSONNEL. A COPY OF SURVEY NOTES SHALL BE FORWARDED TO BUREAU OF TRAFFIC.
4. FOR LEGAL REASONS, STATE POLICE SHALL BE PRESENT DURING THE INSTALLATION OF THESE MARKINGS. (TEL. 603-271-3678).
5. STATE POLICE SHOULD BE NOTIFIED WHEN ANY EXISTING MARKINGS ARE REMOVED DUE TO CONSTRUCTION.

*ARROWS SHOWN ON THIS SHEET INDICATE DIRECTION OF TRAFFIC ONLY

PAVEMENT MARKING STANDARD
SPEED ZONE PAVEMENT MARKINGS