

Wolfeboro 29615

NH Route 28 Improvements

Project Advisory Committee
Meeting #3

June 30, 2022











Agenda

- Welcome and Introductions
- Recap and Update
- Rating Criteria Follow Up
- Alternative Considerations:
 - Pleasant Valley Road Intersection
 - McManus Road Intersection
 - Kingswood Golf Course Pedestrian Crossing
- Pickering Corner Preview
- Schedule Update & Next Steps

Welcome and Introductions

- Town of Wolfeboro
 - Dave Ford, PE, Director of Public Works
 - Tavis Austin, Director of Planning and Development
- Stantec
 - Gerard Fortin, PE, Principal in Charge
 - David McNamara, PE, Project Manager
- NHDOT
 - Jason Ayotte, PE, Project Manager
 - Corey Spetelunas, PE, Group Leader
 - Michael Hlushuk, Design Engineer

Project Information & Website

Project:	Wolfeboro 29615	Status: Design
Scope of Work:	Safety and mobility improvements on Route 28 from the Alton/Wolfeboro Town line to Route 109 (Pickering Corner)	
Contact:	Jason M. Ayotte, P.E. Jason.M.Ayotte@dot.nh.gov  Telephone: (603) 271-3921	
Available Files:	<ul style="list-style-type: none"> ▸ Location Map  ▸ Route 28 Corridor Preliminary Project Planning Report  ▸ Project Roll Plan  ▸ Public Involvement Plan  	
Project Advisory Committee Meeting #3 September 8, 2021 Wolfeboro Town Hall	▸ Agenda 	
Project Advisory Committee Meeting #2 Thursday, July 8, 2021 Wolfeboro Town Hall	<ul style="list-style-type: none"> ▸ Agenda  ▸ Presentation  	
Project Advisory Committee Meeting #1 December 5, 2019 Wolfeboro Town Hall	<ul style="list-style-type: none"> ▸ Presentation  ▸ Meeting Minutes  	

<https://www.nh.gov/dot/projects/wolfeboro29615/index.htm>

<https://www.wolfeboronh.us/planning-development/links/2024-nhdot-route-28-project-materials>

Natural Resources

- Wetland Delineation- Completed for the potential stormwater treatment areas
- NHB Check- Original: no records, Update: potential impacts
- IPaC- NLEB, Small Whorled Pogonia, and Monarch Butterfly (candidate)
 - NLEB: determine if impacts more than 300' from the roadway

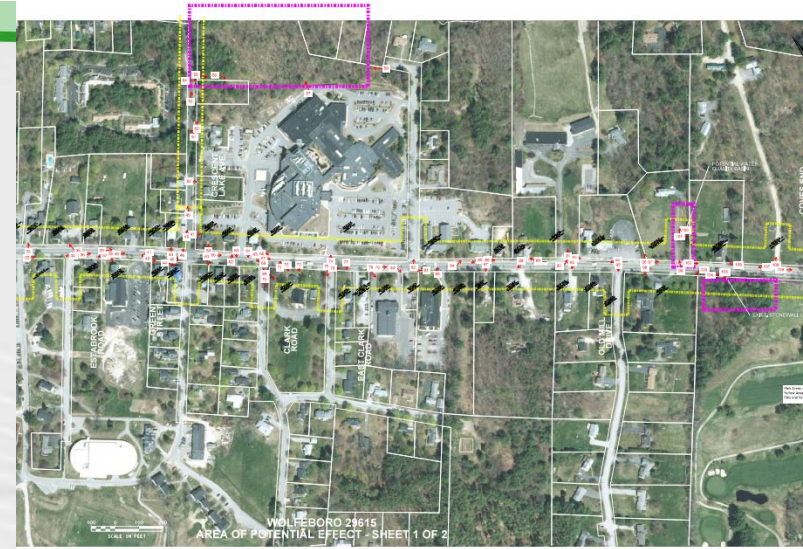

Cultural- Above Ground

- National Register Eligible/Listed Properties:
 - Clark House Museum Complex
 - Brewster Hall
 - Pickering House
 - Huggins Hospital
- Historic District Area Form- draft received from the consultant
- **Next Step:** Complete Determination Review w/ NHDHR

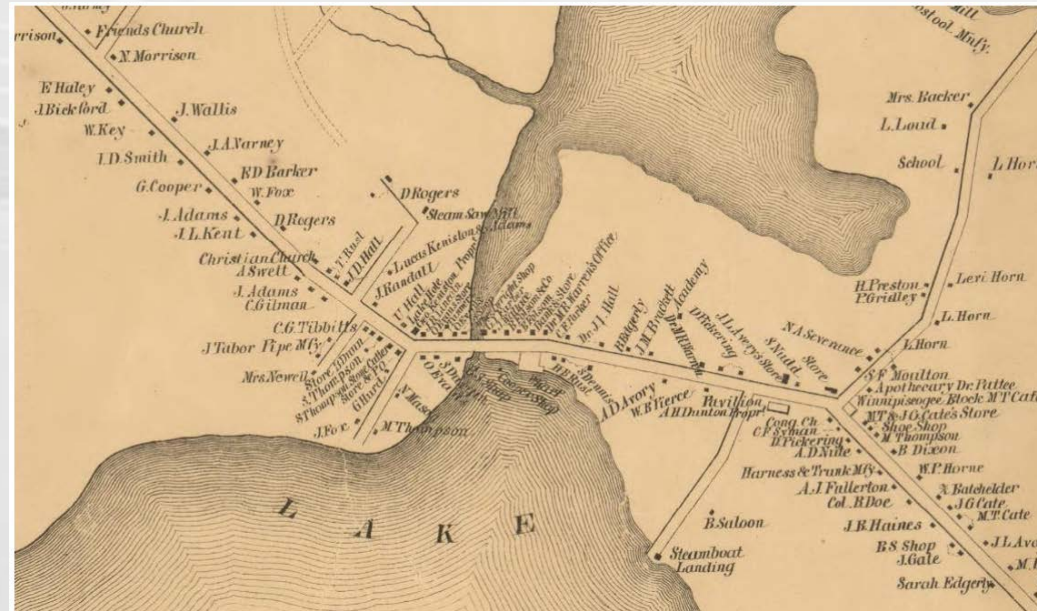
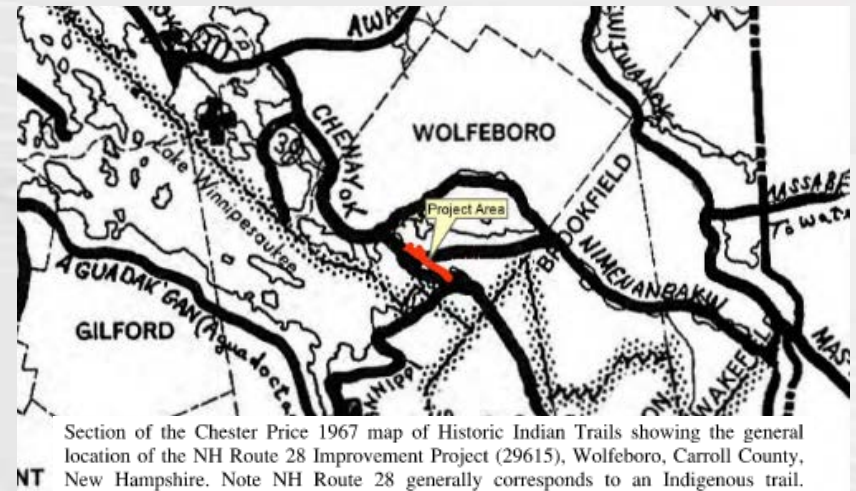

Figure 1
Detail, Map of Smith's Bridge Village, Wolfborough, 1861

Cultural- Below Ground

- Phase IA Archaeological Sensitivity Assessment completed by NE ARC
 - 22 Archeologically Sensitive Areas (ASAs) Identified
 - 39 Historic Yard Spaces- back and side yards of historic structures
 - Recommended Phase IB Intensive Investigation within any portions ASAs or Historic Yard Spaces where project proposes ground disturbance
 - **Next Step:** Determine Alternatives



Town Update

- Water & Sewer Reconstruction
- Tree Inventory

Town of Wolfeboro Tree Inventory and Management Plan | 2022



Submitted by:
Bartlett Tree Experts

Katherine Cummings, Regional Inventory Arborist
ISA Board Certified Master Arborist & Municipal Specialist #NE-7396BM, Massachusetts
Certified Arborist #102013, ISA Tree Risk Assessment Qualified

James VanGyzen, Local Manager
ISA Certified Arborist #NE-6968A



Bartlett Tree Experts
Wolfeboro Office
637 Center Street
Wolfeboro, New Hampshire 03896
603-569-3163
www.bartlett.com

© 2022 F A Bartlett Tree Expert Company. All rights reserved.

Questions?



Location: Crescent Lake Motel; Courtesy www.familyvacationcritic.com

Rating Criteria Follow Up

- Transportation Modes
- Intersection Capacity & Operations
- Property Impacts
- Historic & Cultural Landmarks
- Right-of-Way Requirements
- Lighting & Utilities
- Operation & Maintenance
- Parking/Loading Areas
- **Maintain Village Feel**
- **Differentiate residential/commercial properties**
- **Stormwater & Water Quality**
- **Speed & Traffic Calming**
- **Pedestrian Crossings & Visibility**
- **Costs**

Rating Criteria Follow Up

Sample Criteria:

Criteria:	Pedestrian Safety	Costs	Property Impacts & ROW	Traffic Calming	Stormwater and Water Quality	Maintain Village Feel	Overall
Option 1	●	●	●	●	●	●	●
Option 2	●	●	●	●	●	●	●
Option 3	●	●	●	●	●	●	●

● - Negative

● - No change/neutral

● - Positive

Alternative Considerations

- Maintain Character
- Capacity Improvements – Not a Priority
 - No Reductions
- Town's Priority from CSS Process:
 - Safety
 - Environment
 - Property Rights
 - Historic Resources
 - Scenic Views
 - Economic Impacts

Alternative Considerations

Pleasant Valley Road



Existing conditions:

- Y-shaped Intersection
- Proximity to McManus Road and Kingswood High School drives
- Sidewalks both sides

Alternative Considerations

Pleasant Valley Road - Roundabout



Pros

- Traffic Calming
- Accommodates Pedestrians
- Improved Geometry of Pleasant Valley Intersection

Cons

- Significant ROW Impacts
- Access to Abutting Properties
- Not Feasible with Signalized MacManus Intersection

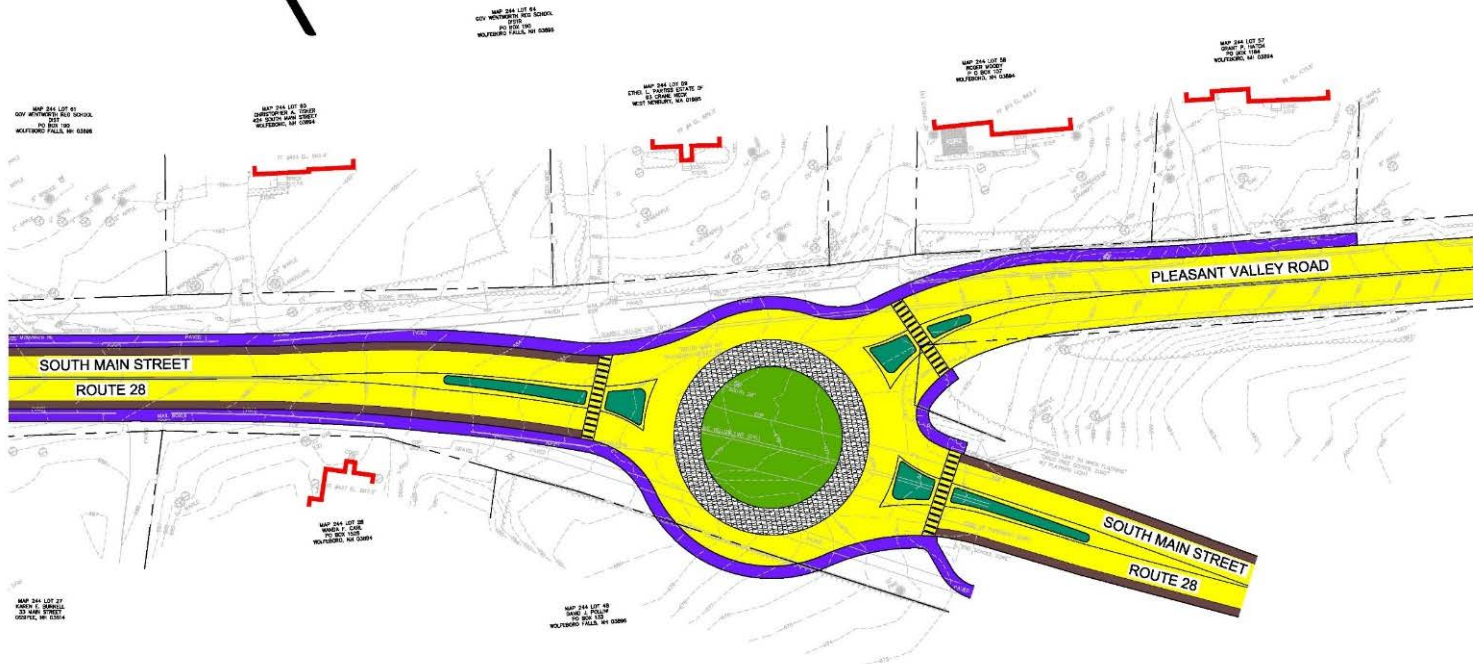

Alternative Considerations

Pleasant Valley Road – Compact Roundabout

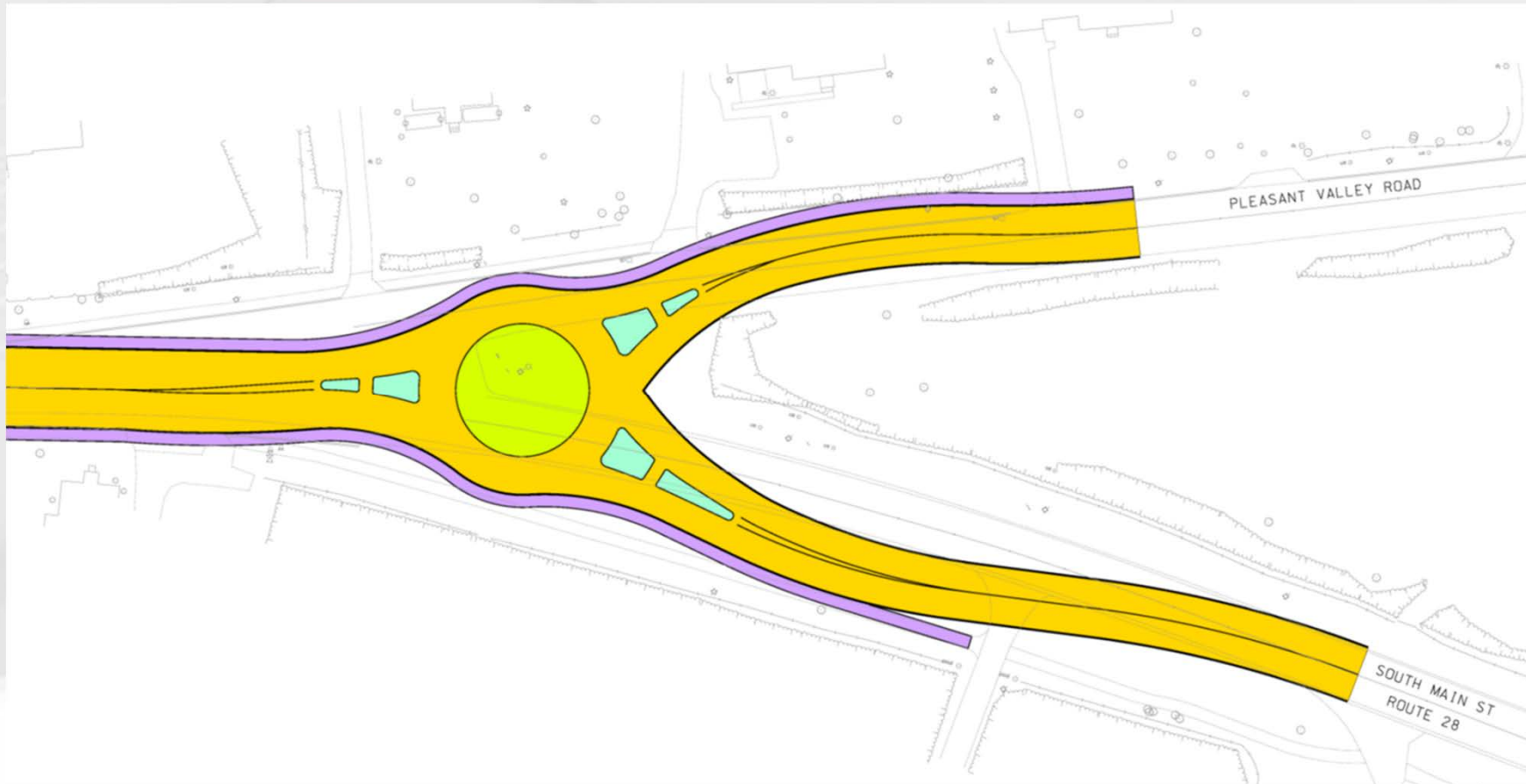

Alternative Considerations

Pleasant Valley Road – T Alignment

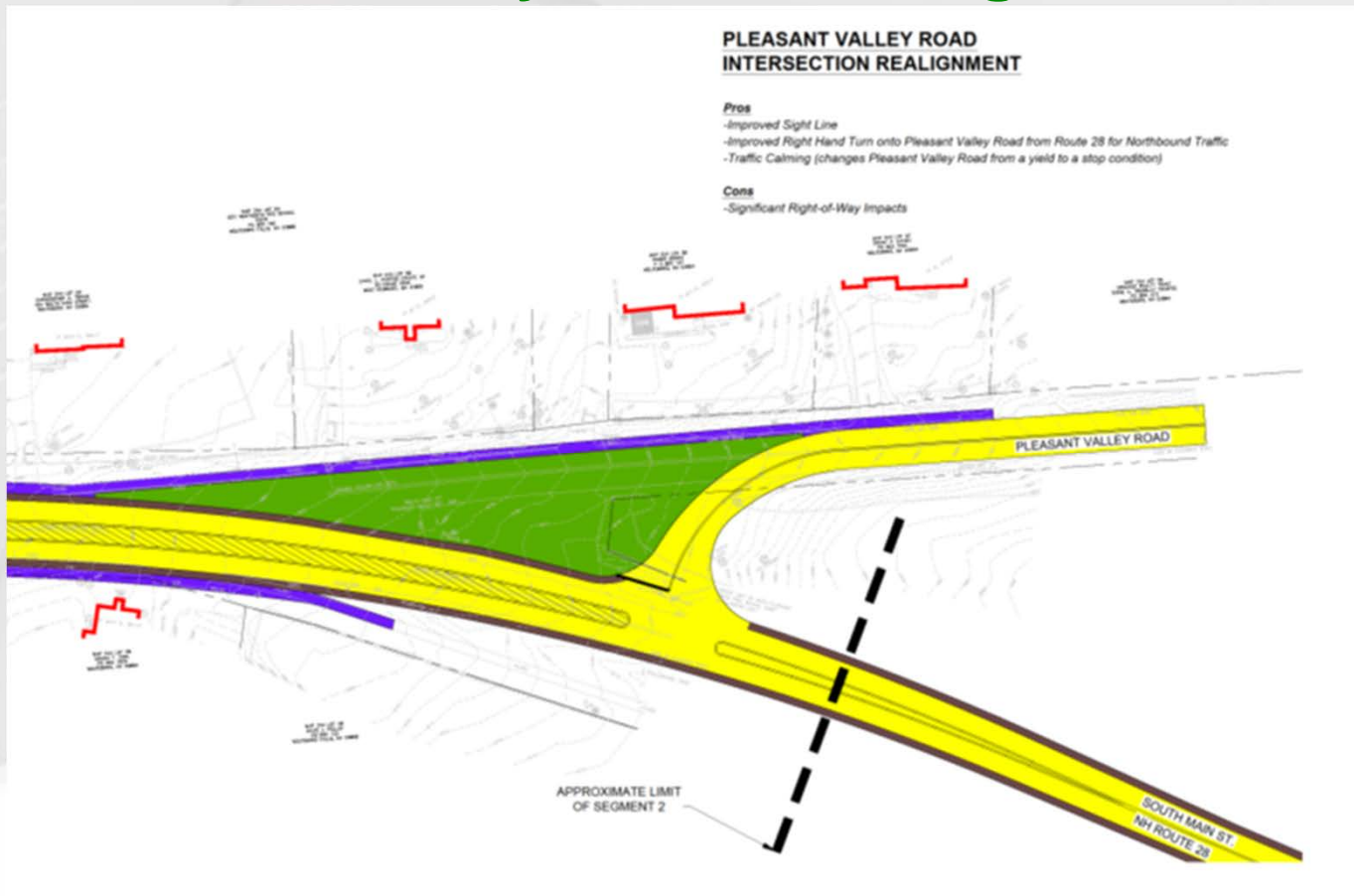

Alternative Considerations

Pleasant Valley Road

Alternatives Summary:

- Consider traffic calming/gateway
- NH 28 north to Pleasant Valley – limited turning ability
- ROW impacts
- Ped/Bike Access

Alternative Considerations

McManus Road



Alternative Considerations

McManus Road

Existing conditions:

- Proximity to Pleasant Valley Road and Kingswood High School drives
- Sidewalks both sides

Alternative Considerations

McManus Road – Turn Lanes



Alternative Considerations

McManus Road - Roundabout

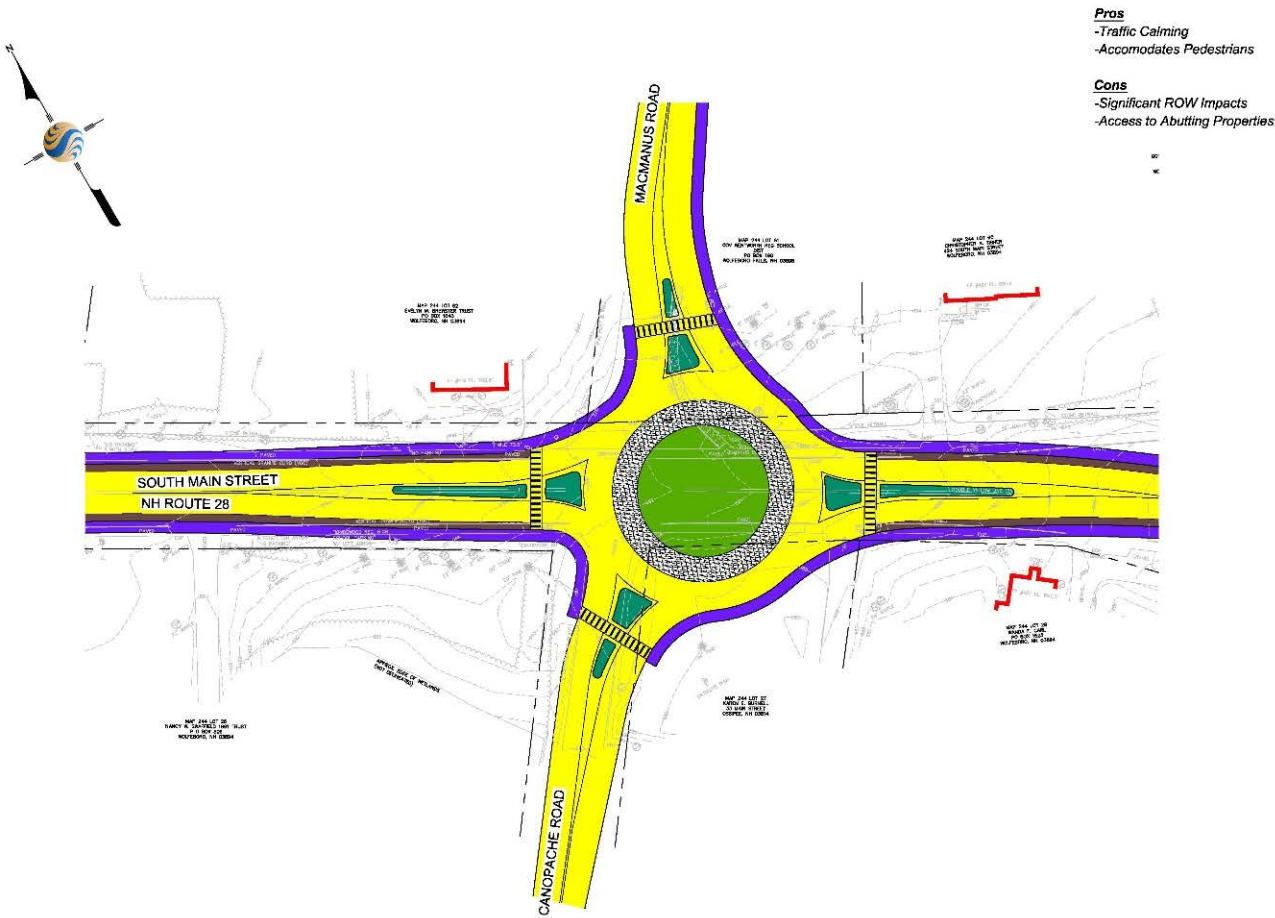

Alternative Considerations

McManus Road – Compact Roundabout

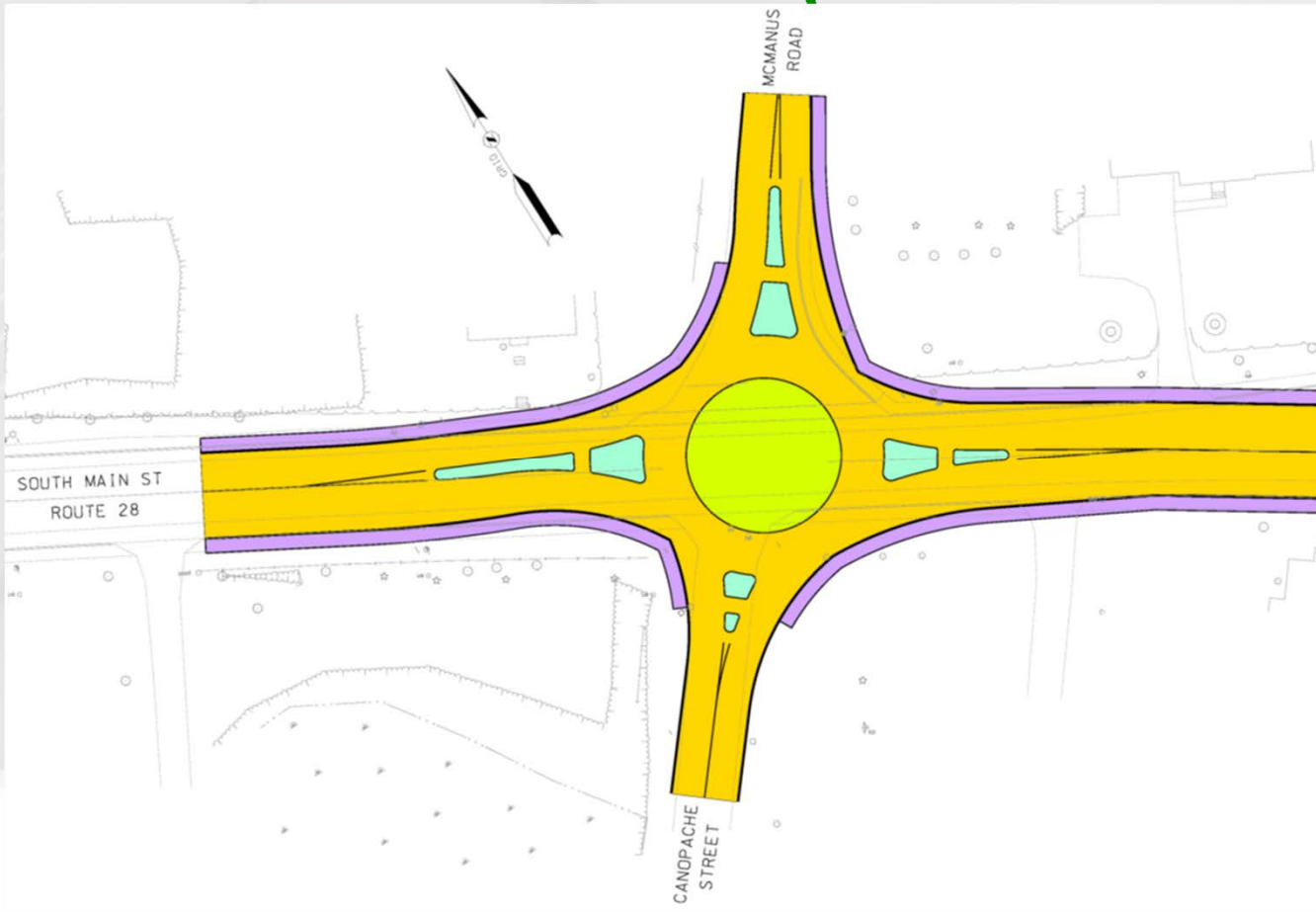

Alternative Considerations

McManus Road

Alternatives Summary:

- Consider traffic calming/gateway
- Interaction with school operations
- ROW impacts
- Ped/Bike Access

Alternative Considerations

Kingwood Golf Course

Existing conditions:

- Skewed Crossing
- Pedestrian crossing sign
- No Crosswalk
- Used by golf carts and walkers
- Speed Limit, 35 mph



Alternative Considerations

Kingswood Golf Course

SEGMENT 3

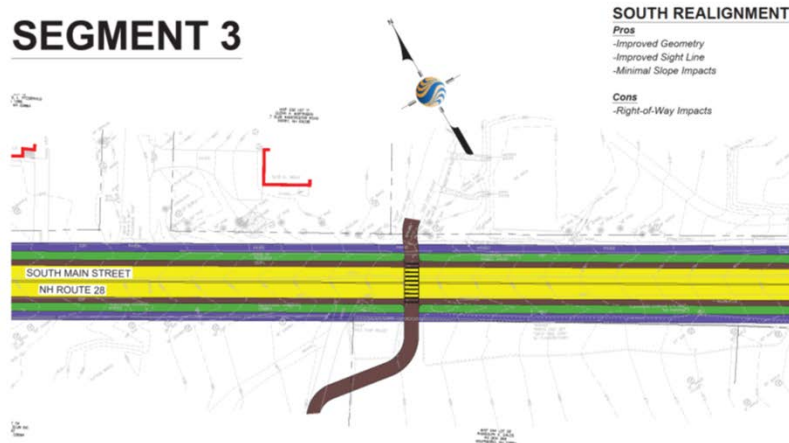

SOUTH REALIGNMENT

- Pros**
- Improved Geometry
 - Improved Sight Line
 - Minimal Slope Impacts
- Cons**
- Right-of-Way Impacts

SOUTH MAIN ST (NH ROUTE 28)
GOLF CART PATH CROSSING
TOWN OF WOLFEBORO, NH

May 24, 2011

Startec Consulting Services Inc.
5 Dartmouth Drive, Suite 101
Auburn, NH 03032
Tel: (603) 659-8872
Fax: (603) 659-7636

SCALE: 1" = 20'



SEGMENT 3

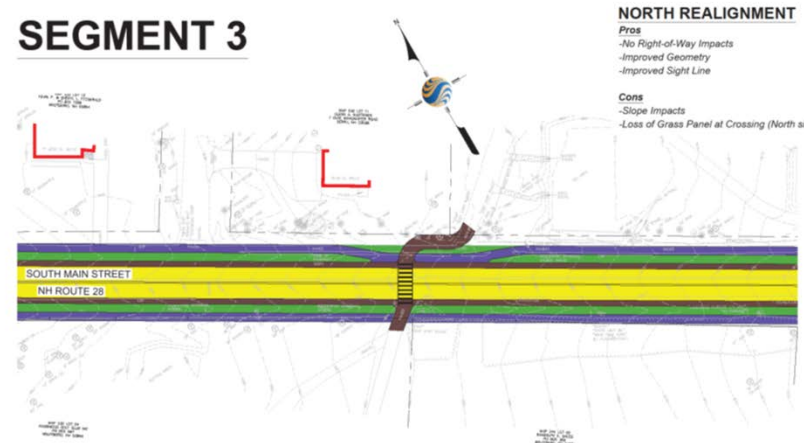

NORTH REALIGNMENT

- Pros**
- No Right-of-Way Impacts
 - Improved Geometry
 - Improved Sight Line
- Cons**
- Slope Impacts
 - Loss of Grass Panel at Crossing (North side only)

SOUTH MAIN ST (NH ROUTE 28)
GOLF CART PATH CROSSING
TOWN OF WOLFEBORO, NH

May 24, 2011

Startec Consulting Services Inc.
5 Dartmouth Drive, Suite 101
Auburn, NH 03032
Tel: (603) 659-8872
Fax: (603) 659-7636

SCALE: 1" = 20'



Alternative Considerations

Kingswood Golf Course

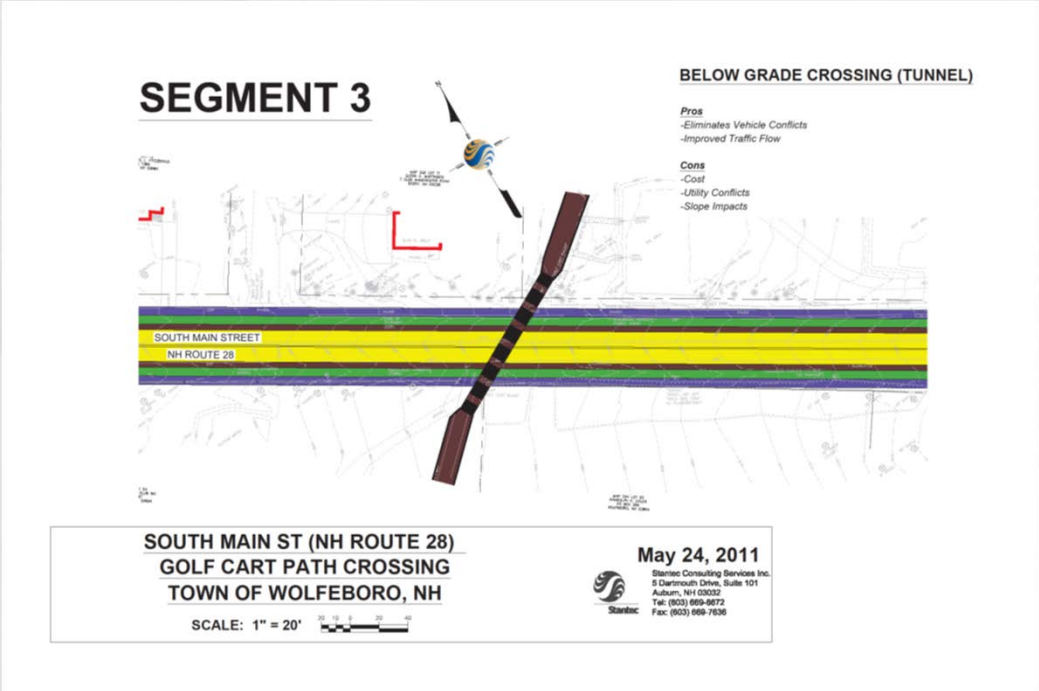

Alternative Considerations

Kingswood Golf Course

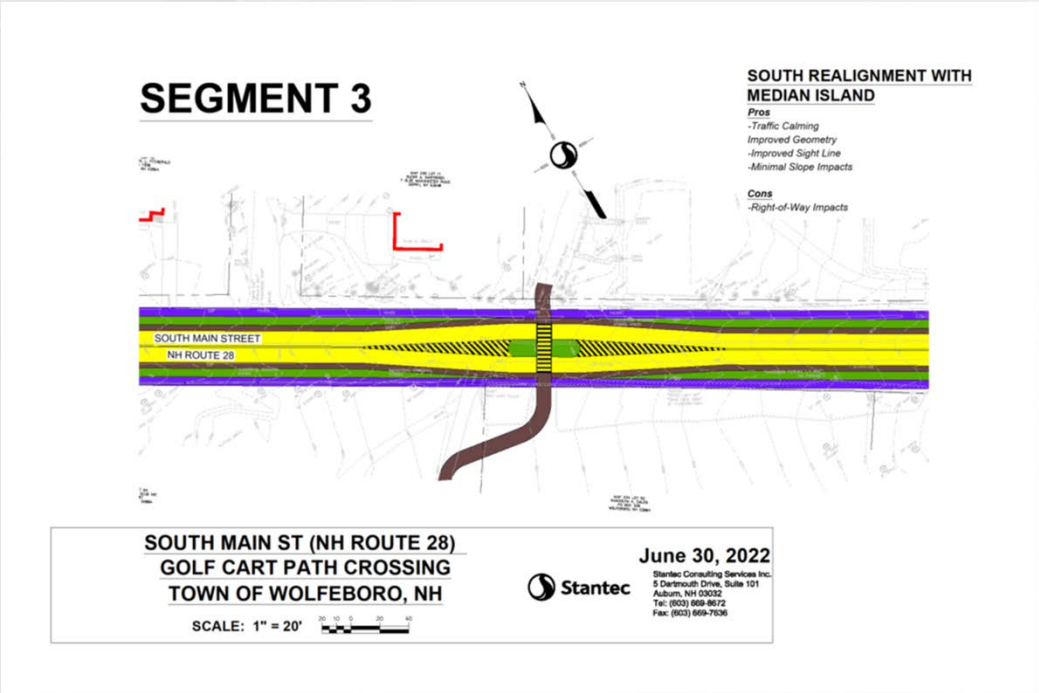

Alternative Considerations

Kingswood Golf Course

Alternatives Summary:

- Realignment options – perpendicular crossing
- Tunnel/below grade
- RRFB's

Pickering Corner

SEGMENT 4

PICKERING CORNER
THREE LEG MINI ROUNDABOUT ALTERNATIVE

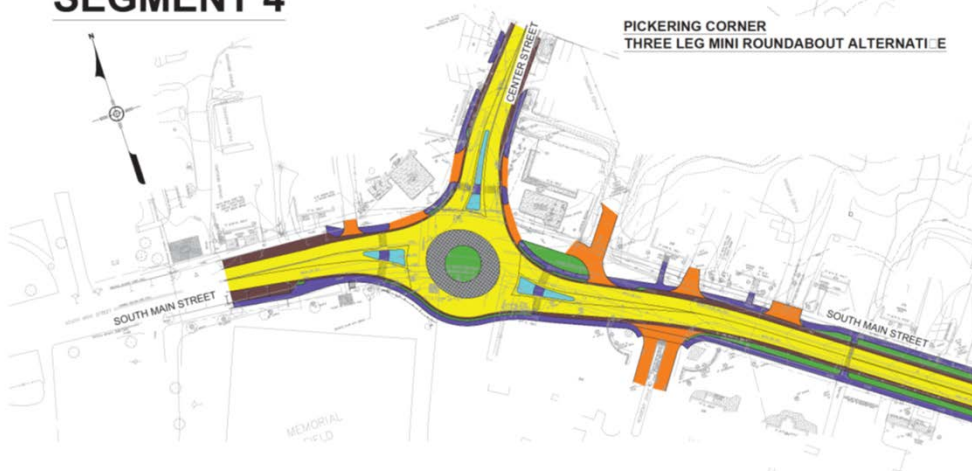

SOUTH MAIN ST (NH ROUTE 28) /
CENTER ST (NH ROUTE 28/109A) INTERSECTION
TOWN OF WOLFEBORO, NH

SCALE: 1" = 30'



ANUAR 2018

Stantec Consulting Services Inc.
3 Dartmouth Drive, Suite 101
Auburn, NH 03032
Tel: (603) 669-6672
Fax: (603) 669-7636



SEGMENT 4

PICKERING CORNER
NO BUILD - UNSIGNALIZED

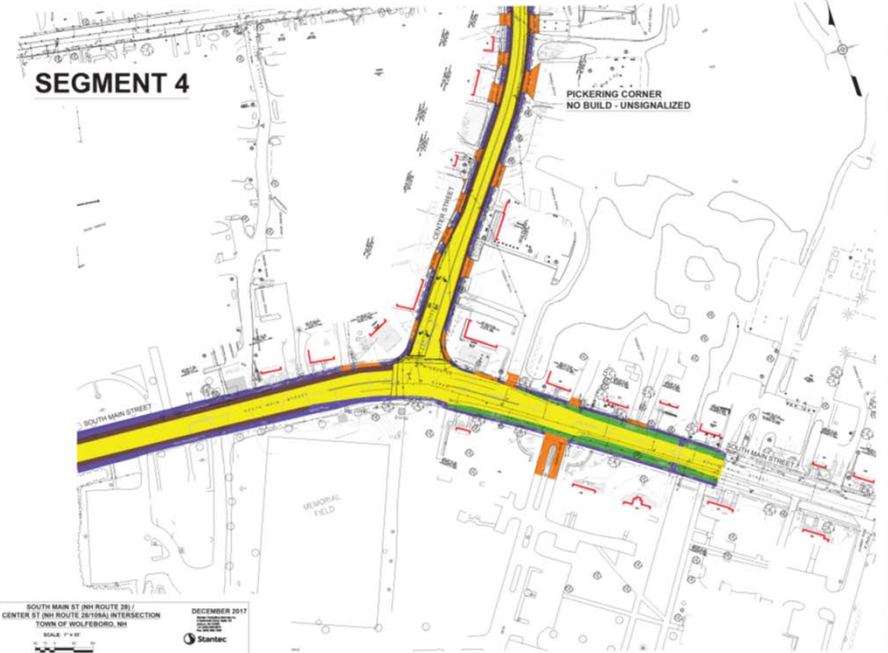

SOUTH MAIN ST (NH ROUTE 28) /
CENTER ST (NH ROUTE 28/109A) INTERSECTION
TOWN OF WOLFEBORO, NH

SCALE: 1" = 30'

DECEMBER 2017



Next PAC Meeting

August 11, 2022

- Pickering Corner Discussion

September 2022

- Typical Section Corridors
 - Roadway/Sidewalk Configurations

October/November

- Public Informational Meeting

Schedule and Next Steps

	PUBLIC INVOLVEMENT	PROJECT DEVELOPMENT
2022	Project Advisory Committee Meetings Public Informational Meetings Neighborhood Stakeholder Meeting	Evaluate Environmental Impacts (wetlands, water quality, etc.) Present and Receive Feedback on Design Alternatives
2023	Public Informational Meeting Public Hearing (Summer)	Publish Environmental Study Non-participating Funding
2024-2026	PAC & Public Official Meetings (Project Updates, As Needed)	Final Design Right-of-Way Acquisitions / Easements Environmental Permitting
2026		Anticipated Start of Construction

Contact Information

Jason Ayotte, PE,
NH DOT Project Manager
603-271-3921
–Jason.M.Ayotte@dot.nh.gov

A photograph of a road intersection. On the left, a paved road leads to a sign that reads "SOUTH 28" with a right-pointing arrow. The main road curves to the right and is lined with dense green trees. The sky is blue with some clouds. The text "• Questions?" is overlaid in white on the right side of the image.

• Questions?